

# MILLING PROMOTION

Cutter for 1€ per mm



Up to Ø 80 mm

+ 50 insets

For Ø 100 - 125 mm

+ 70 insets

For Ø 160 mm

+ 100 insets

## Face Milling

## Square Shoulder Milling

## High Feed Milling

FMA01



EMP01



XMR01



FMA11



EMP02

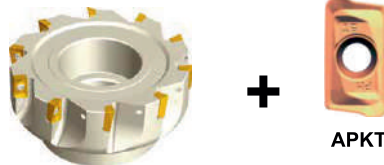

FMP02

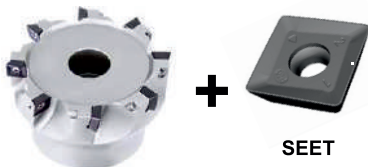

EMP13



FMR02



EMP09

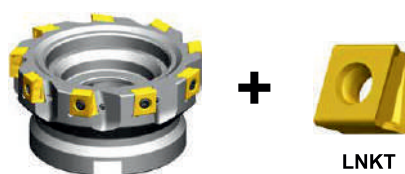

\*The promotion is valid until 30 June 2022 or while stocks last.

# FMA01 Kr: 45° Diameter range Ø50–315

Face milling tool

For steel, stainless steel, cast iron, non-ferrous metals and heat-resistant alloys



- mm
- Milling cutter with positive, soft cutting geometry
- Wiper inserts for good surface quality

Insert geometry \_\_\_\_\_

SEET12T3

Chip breaker \_\_\_\_\_



-DF -CF -EF



-DM -CM -EM



-DR -CR



-LH



-W

Insert grades \_\_\_\_\_

<b>YBC301</b> CVD P15 – P35	<b>YBC302</b> CVD P15 – P35	<b>YBM253</b> CVD P20 – P40 M10 – M30	<b>YBG202</b> PVD P10 – P30 M20 – M30	<b>YBG302</b> PVD P25 – P40 M25 – M40	<b>YB9320</b> PVD P10 – P30 M10 – M25	<b>YBD152</b> CVD K05 – K25	<b>YBD252</b> CVD K15 – K35
<b>YBG101</b> PVD K05 – K25	<b>YD101</b> – K05 – K25						

Machining mode \_\_\_\_\_

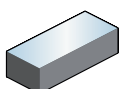

# FMA11

Kr: 45° Diameter range Ø63–315 mm

New face milling generation

For steel, stainless steel and cast iron

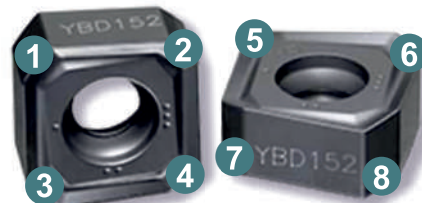

8 Cutting edges

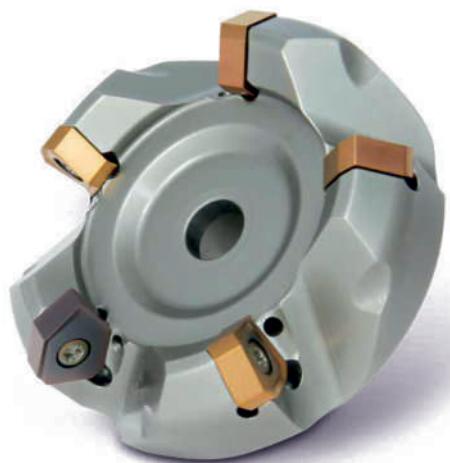

- Inserts with eight cutting edges
- Double sided, thicker inserts for high stability and deeper cutting depths
- Normal and fine pitch

Insert geometry \_\_\_\_\_

SNEG1205ANR SNEG1506ANR SNEG1907ANR

Chip breaker \_\_\_\_\_



Insert grades \_\_\_\_\_

<b>YBC302</b>	<b>YBM253</b>	<b>YBG205</b>	<b>YB9320</b>	<b>YBD152</b>	<b>YBD252</b>
CVD P15 – P35	CVD P20 – P40	PVD P10 – P30 M20 – M30	PVD P15 – P25 M10 – M25	CVD K05 – K25	CVD K15 – K35

Machining mode \_\_\_\_\_

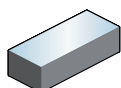

# FMP02 Kr: 90° Diameter range Ø50–315 mm

Face milling tool

For steel, stainless steel, cast iron and non-ferrous metals



- Low cutting forces
- Large variation of grades

Insert geometry \_\_\_\_\_

SEET09T3 SEET1203

Chip breaker \_\_\_\_\_

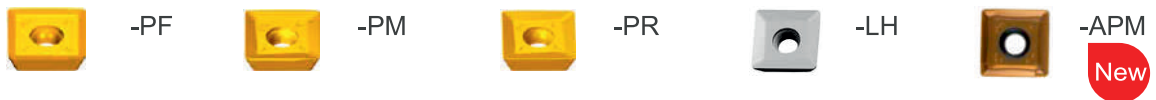

Insert grades \_\_\_\_\_

<b>YBC301</b> CVD P15 – P35	<b>YBC302</b> CVD P15 – P35	<b>YBM251</b> CVD P10 – P30 M20 – M30	<b>YBM351</b> CVD P10 – P30 M20 – M30	<b>YBG202</b> PVD P10 – P30 M20 – M30	<b>YBG302</b> PVD P25 – P40 M25 – M40	<b>YBD152</b> CVD K05 – K25	<b>YBD252</b> CVD K15 – K35
<b>YBG101</b> PVD K05 – K25	<b>YBG102</b> PVD K05 – K25	<b>YD101</b> – K05 – K25	<b>YB9320</b> PVD P10 – P30 M20 – M30				

Machining mode \_\_\_\_\_

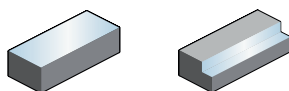

# FMR02

Face milling tool

For steel, stainless steel, cast iron, non-ferrous metals and heat-resistant alloys



- Diameter range Ø50–250 mm
- Screw clamping
- Large variation of grades
- Best features for heat-resistant alloys

Insert geometry \_\_\_\_\_

RCKT1204 RCKT1606 RCKT2006

Chip breaker \_\_\_\_\_



Insert grades \_\_\_\_\_

<b>YBC301</b> CVD P15 – P35	<b>YBC302</b> CVD P15 – P35	<b>YBC401</b> CVD P30 – P40	<b>YBM251</b> CVD P20 – P40 M10 – M30	<b>YBM253</b> CVD P20 – P40 M10 – M30	<b>YBM351</b> CVD P10 – P30 M20 – M30	<b>YBG202</b> PVD P10 – P30 M20 – M30	<b>YB9320</b> PVD P10 – P30 M20 – M30
<b>YBG205</b> PVD P10 – P30 M20 – M30	<b>YBG212</b> PVD P10 – P30 M20 – M30	<b>YBG302</b> PVD P25 – P40 M25 – M40	<b>YBD152</b> CVD K05 – K25	<b>YBD252</b> CVD K15 – K35	<b>YBS203</b> PVD S15 – S25	<b>YBS303</b> PVD S25 – S35	

Machining mode \_\_\_\_\_

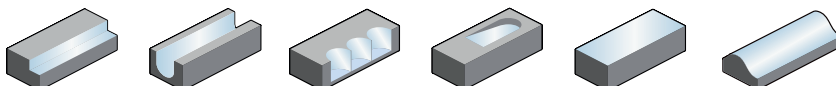

# EMP01/02 Kr: 90°

Square shoulder mill Diameter range Ø16–250 mm

For steel, stainless steel, cast iron, non-ferrous metals and heat-resistant alloys



- Milling cutter with positive, soft cutting geometry
- Inserts with two cutting edges

## Insert geometry \_\_\_\_\_

APKT0702-0,4  
APKT11T3-0,4 0,8 1,2 1,6 2,0

APKT11T3-XR  
High feed Milling Insert for EMP01/02 **New**

APKT1604-0,8 1,6 2,0 2,4 3,0

## Chip breaker \_\_\_\_\_

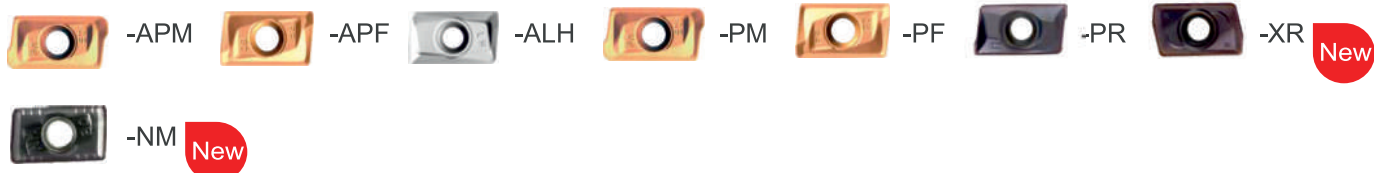

## Insert grades \_\_\_\_\_

<b>YBC301</b> CVD P15 – P35	<b>YBC302</b> CVD P15 – P35	<b>YBM253</b> CVD P20 – P40 M10 – M30	<b>YBG202</b> PVD P10 – P30 M20 – M30	<b>YB9320</b> PVD P10 – P30 M20 – M30	<b>YBG302</b> PVD P25 – P40 M25 – M40	<b>YBD152</b> CVD K05 – K25	<b>YBD252</b> CVD K15 – K35
<b>YBG101</b> PVD K05 – K25	<b>YD101</b> – K05 – K25	<b>YBS203</b> PVD S15 – S25	<b>YBS303</b> PVD S25 – S35				

## Machining mode \_\_\_\_\_

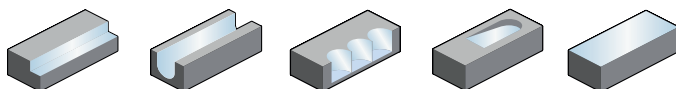

# EMP09

Kr: 90° Diameter range Ø40–125 mm

## Square shoulder mill

For steel, stainless steel and cast iron



- Sharp cutting edge geometry combined with robust tangential inserts
- First choice for large cutting depths with high feed rates

Insert geometry \_\_\_\_\_

LNKT080404PNR

LNKT120608PNR

Chip breaker \_\_\_\_\_

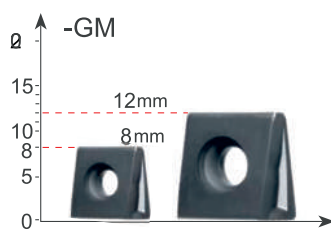

Insert grades \_\_\_\_\_

YBM253

CVD  
P20 – P40  
M10 – M30

YB9320

PVD  
P10 – P30  
M20 – M30

YBD252

CVD  
K15 – K35

Machining mode \_\_\_\_\_

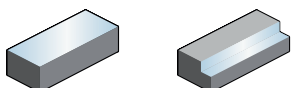



# EMP13 Kr: 90° Diameter range Ø40–250 mm

Square shoulder mill

For steel, cast iron and non-ferrous metals



- Double sided, thicker inserts for high stability and deeper cutting depths
- Inserts with four cutting edges

Insert geometry \_\_\_\_\_

ANGX1105 ANGX1506

Chip breaker \_\_\_\_\_

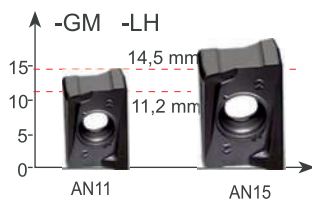

Insert grades \_\_\_\_\_

<b>YBC302</b>	<b>YBM253</b>	<b>YBG205</b>	<b>YB9320</b>	<b>YBD152</b>	<b>YBD252</b>	<b>YD101</b>
CVD	CVD	PVD	PVD	CVD	CVD	-
P15 – P35	P20 – P40 M10 – M30	P10 – P30 M20 – M30	P10 – P30 M20 – M30	K05 – K25	K15 – K35	K05 –

Machining mode \_\_\_\_\_

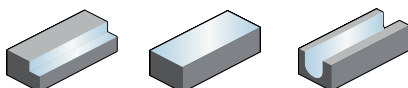



# XMR01

Kr: 11°–22° Diameter range Ø20–160 mm

High feed mill



3 Cutting edges WPGT\*

For steel, stainless steel and cast iron



4 Cutting edges SDMT\*



- Inserts with three or four cutting edges
- Double clamping system for inserts
- Ramping possible

Insert geometry \_\_\_\_\_

WPGT0503 WPGT0604 WPGT0806 WPGT0907  
SDMT06T2 SDMT09T3 SDMT1204 SDMT1505

Chip breaker \_\_\_\_\_



-PM



-ZSR



-PM



-DM



-NM

New

Insert grades \_\_\_\_\_

<b>YBC302</b> CVD P15–P35	<b>YBG202</b> PVD P10–P30 M20–M30	<b>YBG205</b> PVD P10–P30 M20–M30	<b>YBM253</b> CVD P20–P40 M10–M30	<b>YB9320</b> PVD P10–P30 M10–M25	<b>YBG212</b> PVD M20–M30	<b>YBD152</b> CVD K05–K25	<b>YBD252</b> CVD K15–K35
<b>YBS203</b> PVD S15–S25	<b>YBS303</b> PVD S25–S35						

Machining mode \_\_\_\_\_

